

HWD 90 Fire protection boxes.

Now also for wooden panel and timber frame construction.

Fire protection boxes with extended approval.





For drywall in timber construction

Since the introduction of the first fire-protection box for fire-protection walls in 2006, the range of applications has been continually expanded. **HWD 90 fire-protection boxes** are now also approved for **timber walls in timber frame or timber panel construction**. They maintain the fire protection properties of the wall with a fire-resistance duration of EI30 and EI60. No additional measures, such as encasing, are necessary. Even if installed on the opposing side, the fire protection of the wall is guaranteed for 30 or 60 minutes.

- For fire-protection walls in timber construction EI30 and EI60
- For timber frame or timber panel construction walls
- Also for wall systems with wood fibre insulation
- Retrofitting possible
- For direct installation to the opposing side

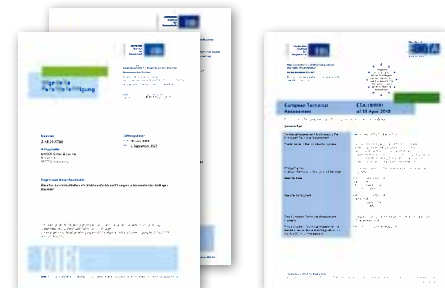

Type approvals
Z-19.21-1788
Z-19.21-2064

EOTA
ETA-18/0091

The current certificates for the corresponding products are available for you to download at www.kaiser-elektro.de.

Ø 74 mm



**HWD 90 one-gang box
9463-01**

- Depth: 44 mm
- 2 cable entries

Ø 74 mm



**HWD 90 one-gang junction box
9464-01**

- Depth: 54,5 mm
- 4 cable entries

Ø 2x 74 mm



**HWD 90 electronics box
9462-94**

- Extra-large terminal compartment for communications and network technology
- Additional space for electronic components (KNX actuators, relays, radio modules, communications technology)
- Can also be used as a **double box**
- Depth: 70 mm
- 4 conduit entries, 4 cable entries



- 1 The effect of the heat causes the fire-retardant coating to intumesce and prevents the fire and smoke from spreading.
- 2 For wooden panel construction or wooden frame construction walls EI30 and EI60 with glass wool, rock wool or wood fiber insulation.
- 3 The fire protection function is maintained even when boxes are installed directly opposite each other.
- 4 In an EI60 wall, combinations of up to three each are possible. With an EI30 wall, combinations up to 5 each are possible.
- 5 The HWD 90 electronics box is also approved for the above mentioned wall constructions.

The **proven installation** has not changed. Installations directly opposing each other are possible even in timber construction up to fire resistance class EI30 (max. 5-fold combination) or EI60 (max. 3-fold combination).

All boxes of type HWD 90 maintain the sound insulation function completely up to a sound insulation level of 77 dB.

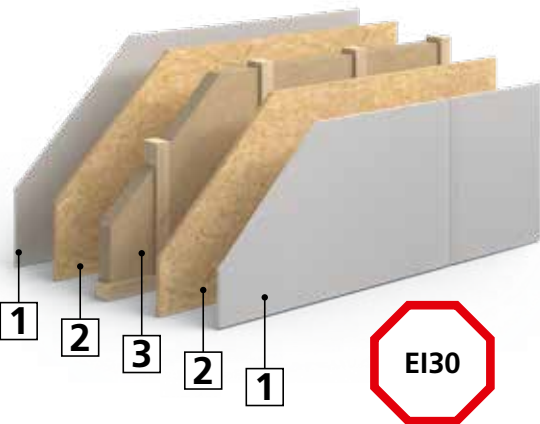

- 1 9.5 mm plasterboard
- 2 15 mm OSB/MDF, plywood or chipboard
- 3 40 mm wood fibre insulation, glass or rock wool
60x40 wooden beams

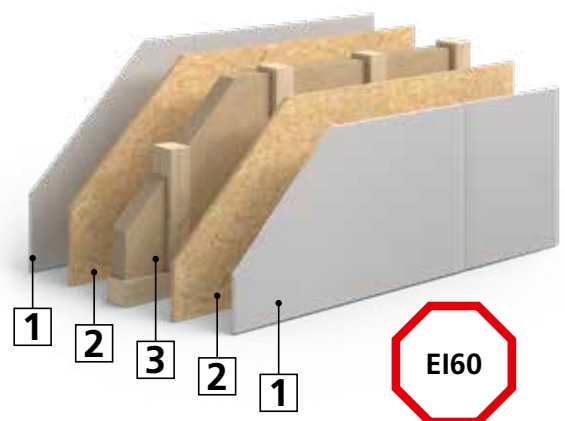

- 1 12.5 mm plasterboard fire protection board
- 2 15 mm OSB/MDF, plywood or chipboard
- 3 60 mm wood fibre insulation, glass or rock wool
40x80 wooden beams

Certified. Safety built into the wall.

HWD 90 fire protection boxes and the HWD 90 electronics box are particularly versatile - true multi-geniuses. HWD 68 fire protection boxes form the basis of good fire protection. The table shows the permitted areas of application.



9463-01



9464-01



9462-94



9463-02







9464-02

HWD 90 one-gang box / appliance connection box

HWD 90 electronics box

HWD 68 one-gang box / appliance connection box

| Wall type / wall construction | Minimum requirement of the wall | Installation level | HWD 90 one-gang box / appliance connection box | | | | HWD 90 electronics box | | | | HWD 68 one-gang box / appliance connection box | | | |
|---|--|--------------------------------|--|------|------|-------|------------------------|------|--------------------|-------|--|-----------|-----------|-------|
| | | | EI30 | EI60 | | | EI30 | EI60 | | | EI30 | EI60 | | |
| Wood frame and wood panel construction   | <ul style="list-style-type: none"> Minimum wall thickness 109 mm (EI30) 135 mm (EI60) Wooden stand 40 x 60 mm (EI30) 60 x 80 mm (EI60) Boarding on both sides 1 x 15 mm wooden panels (e.g. OSB) EI30 with 1 x 9.5 mm GKB EI60 with 1 x 12.5 mm GFK Wood fibre insulation 50 kg/m³ Glass wool 14 kg/m³ Rock wool 40 kg/m³ | 30 cm from the ceiling | ✓ | ✓ | | | ✓ | ✓ | not for glass wool | | | | | |
| | | 115 cm from the finished floor | ✓ | ✓ | | | ✓ | ✓ | not for glass wool | | | | | |
| | | 105 cm from the finished floor | ✓ | ✓ | | | ✓ | ✓ | not for glass wool | | | | | |
| | | 30 cm from the finished floor | ✓ | ✓ | | | ✓ | ✓ | not for glass wool | | | | | |
| | | | EI30 | EI60 | EI90 | EI120 | EI30 | EI60 | EI90 | EI120 | EI30 | EI60 | EI90 | EI120 |
| DIN - Wall  | <ul style="list-style-type: none"> Minimum wall thickness 100 mm Metal or wooden stand Boarding on both sides 2 x 12.5 mm GFK sheets Mineral insulation > 1,000°C | 30 cm from the ceiling | ✓ | ✓ | ✓ | ✓ | ✓ | ✓ | ✓ | ✓ | ✓ | ✓ | ✓ | |
| | | 115 cm from the finished floor | ✓ | ✓ | ✓ | ✓ | ✓ | ✓ | ✓ | ✓ | ✓ | ✓ | ✓ | ✓ |
| | | 105 cm from the finished floor | ✓ | ✓ | ✓ | ✓ | ✓ | ✓ | ✓ | ✓ | ✓ | ✓ | ✓ | ✓ |
| | | 30 cm from the finished floor | ✓ | ✓ | ✓ | ✓ | ✓ | ✓ | ✓ | ✓ | ✓ | ✓ | ✓ | ✓ |
| Approved wall (abP, abZ or aBG)  | <ul style="list-style-type: none"> Minimum wall thickness 100 mm Metal or wooden stand Boarding on both sides 2 x 12.5 mm cement or Gypsum bonded building panels With or without insulation <p> abZ: general technical approval abP: general building authority test certificate aBG: general type approval </p> | 30 cm from the ceiling | ✓ | ✓ | ✓ | | ✓ | ✓ | ✓ | | > 1,000°C | > 1,000°C | > 1,000°C | |
| | | 115 cm from the finished floor | ✓ | ✓ | ✓ | | ✓ | ✓ | ✓ | | > 1,000°C | > 1,000°C | > 1,000°C | |
| | | 105 cm from the finished floor | ✓ | ✓ | ✓ | | ✓ | ✓ | ✓ | | > 1,000°C | > 1,000°C | > 1,000°C | |
| | | 30 cm from the finished floor | ✓ | ✓ | ✓ | | ✓ | ✓ | ✓ | | > 1,000°C | > 1,000°C | > 1,000°C | |
| Shaft wall  | <ul style="list-style-type: none"> Metal stand Single-sided boarding For one-gang boxes 2 x 20 mm For junction boxes 2 x 25 mm Cement or gypsum-based building panels EI30 no insulation EI60 30/m³, > 1,000°C EI90 Termarock 100, 100 kg/m³ <p>Note: the use of the HWD 90 in shaft walls is approved in Germany by the general type approval. If the device is to be used in other countries, the applicable certificates, standards, guidelines or regulations must be observed.</p> | 30 cm from the ceiling | ✓ | ✓ | ✓ | | | | | | | | | |
| | | 115 cm from the finished floor | ✓ | ✓ | ✓ | | | | | | | | | |
| | | 105 cm from the finished floor | ✓ | ✓ | ✓ | | | | | | | | | |
| | | 30 cm from the finished floor | ✓ | ✓ | ✓ | | | | | | | | | |

The link takes you directly to the solution area for electrical installation concerning fire protection on the KAISER website https://www.kaiser-elektro.de/en_DE/solutions/fire-protection/

Technical information and advice

All further information on products, system solutions and communication media can be found on our website: www.kaiser-elektro.de

For any additional questions or information, please do not hesitate to contact our technical support team who will be happy to assist you: **+49 (0) 2355 / 809-61** · technik@kaiser-elektro.de

KAISER GmbH & Co. KG

Ramsloh 4 · 58579 Schalksmühle
 GERMANY
 Tel. +49(0)2355.809.0 · Fax +49(0)2355.809.21
www.kaiser-elektro.de · info@kaiser-elektro.de



produkt video

KAISER
 The basis for good installation